

Plastic supply and exhaust valve KPP



Description

The KPP damper valve is stuck in both hot water and exhaust systems. It is made from white PVC to make it resistant to corrosion. The air flow is adjusted by turning the central part of the valve. The vibration gap is fixed using an additional lock nut. The special design of the valve ensures low noise levels. The KPP valve is connected to a cable behind an additional mounting frame, which is included with the valve. Before installation, simply press the valve into the frame.

Example of designation

Product code:

KPP - aaa

type _____

Ød₁ _____

Dimensions

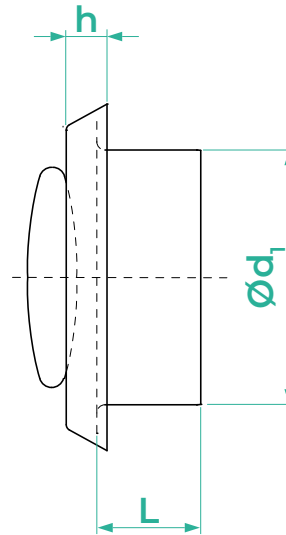

Code	Ød ₁ (mm)	L (mm)	h (mm)
KPP-100	100	50	15
KPP-125	125	50	15
KPP-150	150	50	15
KPP-160	160	50	15
KPP-200	200	50	15

Fall graphs pressure

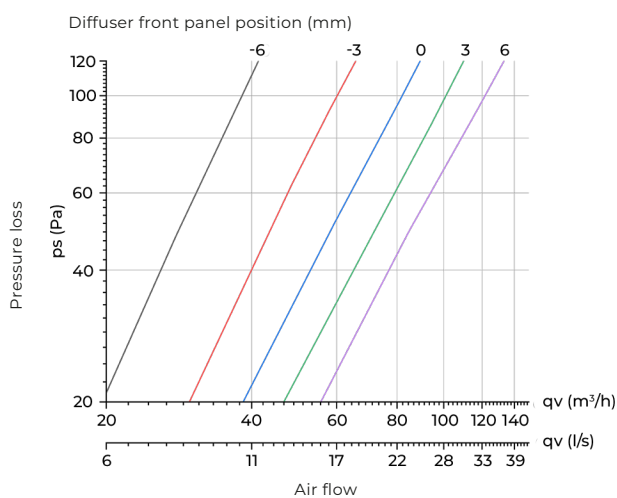

Graphs of pressure drop of KPP-100 in the supply function

Fall graphs pressure

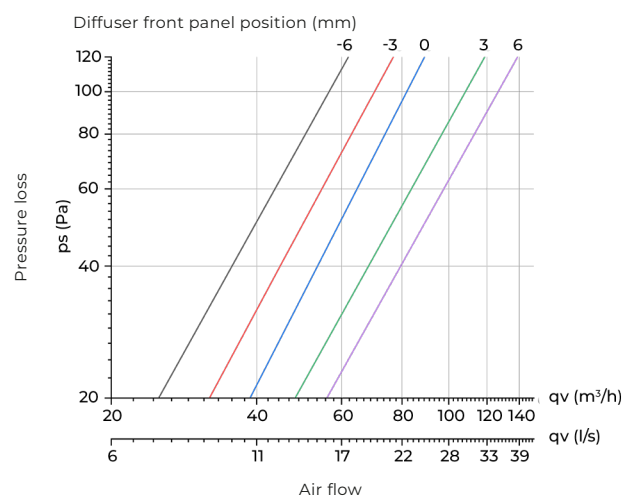

Graphs of pressure drop of KPP-100 in the supply function

Plastic supply and exhaust valve KPP

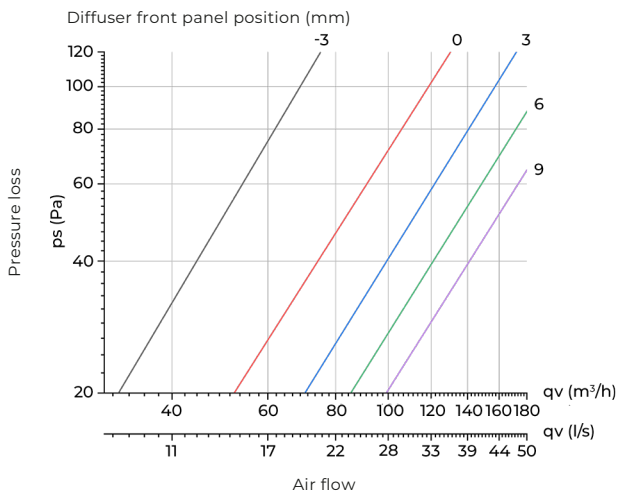

Graphs of pressure drop of KPP-125 in the supply function

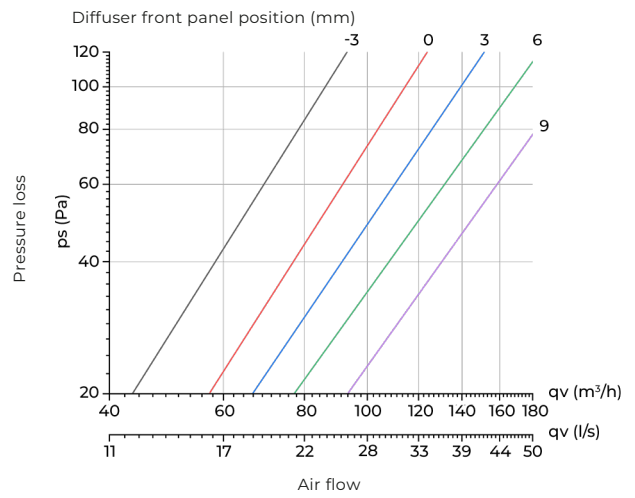

Graphs of pressure drop of KPP-150 in the supply function

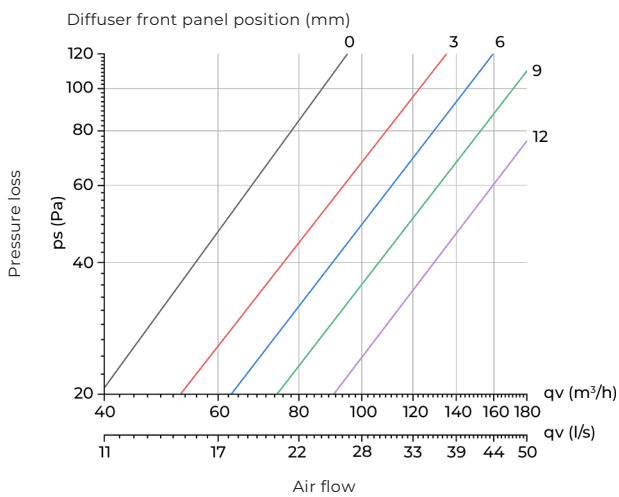

Graphs of pressure drop of KPP-125 in the supply function

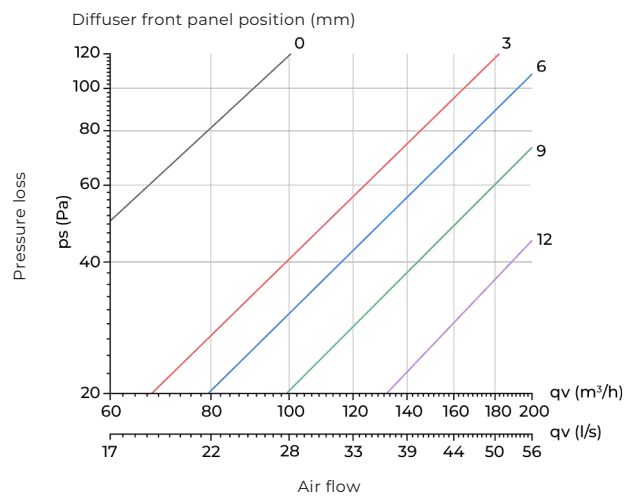

Graphs of pressure drop of KPP-200 in the supply function

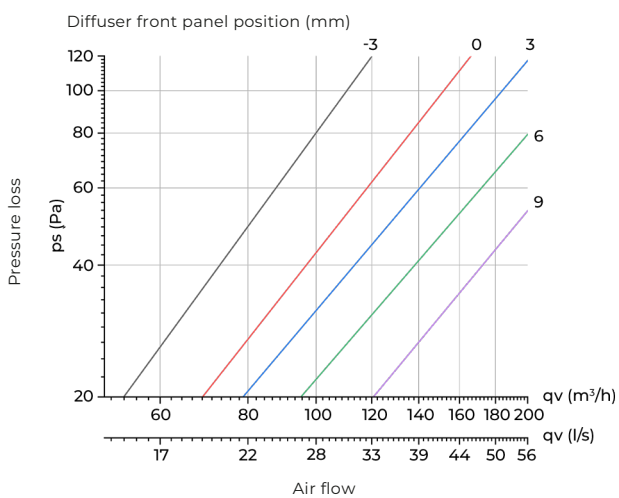

Graphs of pressure drop of KPP-150 in the supply function

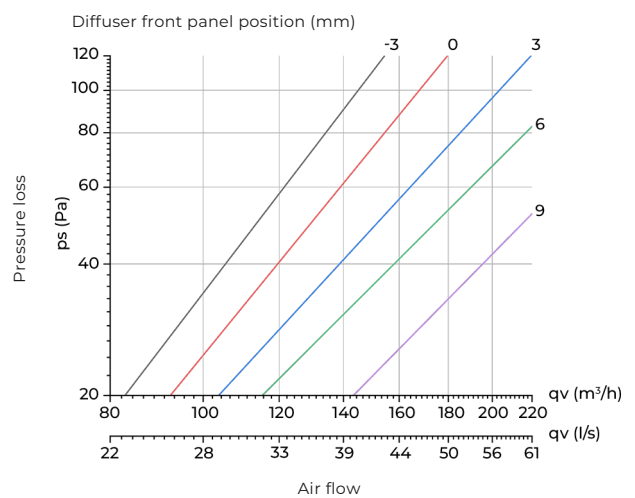

Graphs of pressure drop of KPP-200 in the supply function